

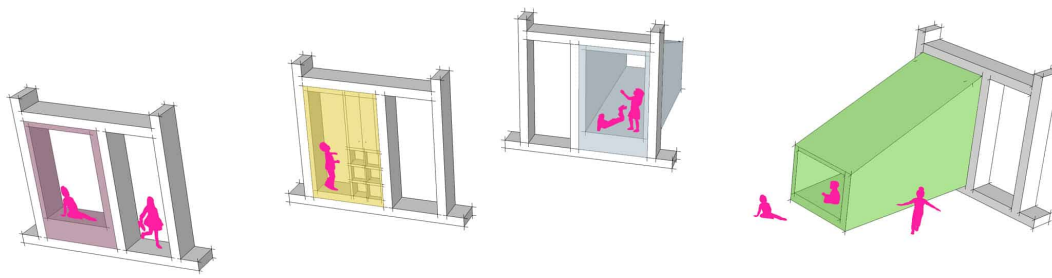

Beiersdorf Children's Day Care Centre 'Troplo Kids'

Typology education **Location** Hamburg **Construction Volume** GFA 1,750 m², GV 7,000 m³
Client Beiersdorf AG **Realisation** 2012-2013 **Certificate** DGNB Platin **Award** BDA Preis
Hamburg – honorable mention



#Children's day care centre for 7 groups

The colourful facade frames are a characteristic feature of the new kindergarten on the outside and a means to provide varied space for creative play inside.



Photo Werner Huthmacher

The two-storey new build is located next to a green area on the inner-city grounds of the Beiersdorf AG in Hamburg-Eimsbüttel. The extremely compact rectangular structure is arranged around a central, two-storey multi-purpose room, which functions as a play area and gathering space. The inspiration for the design came from the history of the Beiersdorf AG in that the kindergarten resembles an abstract version of an apothecary cabinet. Featuring a shelf-like structure, the facade caters for a variety of functions and requirements and, at the same time, creates a light and transparent atmosphere indoors.

The large window formats provide perfect conditions for play and educational work.



Photo Werner Huthmacher

The multi-purpose room, a two-storey multi-functional hall, is the heart of the building – the communicative centre for children and carers. It functions as a distributor to the various functional zones and a space for communal activities.